

Outer shell	: Brass (UNS C38500)	Chrome plated (FS-QQ-C-320B)
Earthing crown	: Cu-Be (UNS C17200)	Gold plated (ISO 27874)
Collet nut	: Brass (UNS C38500)	Chrome plated (FS-QQ-C-320B)
Insulator	: PTFE	-
Male contact	: Brass (UNS C38500)	Gold plated (ISO 27874)
Tapered washer	: Brass (UNS C38500)	Nickel plated (FS-QQ-N-290A)
Other metallic parts	: Brass (UNS C38500)	Nickel plated (FS-QQ-N-290A)
O-Ring	: Silicone (MVQ)	-
Label	: Polyester	Yellow

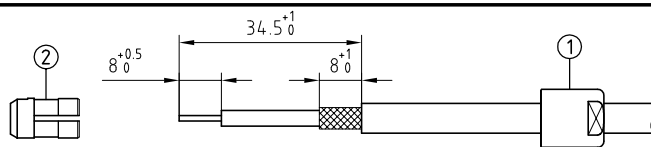

1. Verify the connector is clean, if not clean carefully. Strip the cable according to the given dimensions. Slide it into the collet nut (1) and the collet (2).

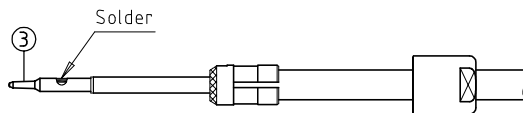

2. In case of a screened cable, fold screen back over the extremity of the collet. Slide the conductor into the contact (3) until the dielectric of the cable strike against the contact and solder. Make sure that there is no solder over thickness.

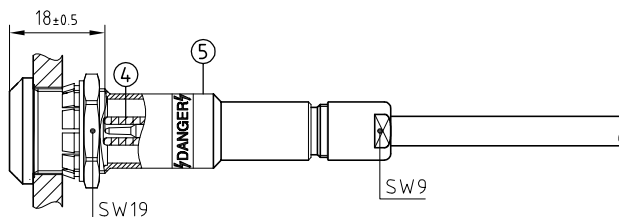

3. Drill the panel hole and install the connector with the appropriate tool. Introduce the contact in the main insulator (4) which is already placed in the connector shell (5). Verify that the contact is correctly positionned (position must be 18±0.5mm from the front of the straight shell). Push the collet into the straight shell and cut the screen in excess. Screw the collet nut with the appropriate tool and tighten to the maximum torque value of 1.5Nm.

Panel cut-out

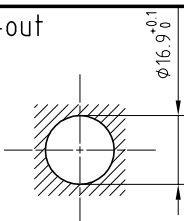

Torque for mounting nut : 7 Nm

Flat spanners set

: DCP.91.001.TN

**Straight socket nut fixing, with cable collet.**  
**Series 1Y, (1) HV(φ1.4)**

ETUDE N° E7195

Echelle	Dessiné	12.03.2018	OVU / NHA
	Contrôle	12.03.2018	NHA / ATVI
	Modif.	00	12.03.2018/ OVU



**LEMO**

LEMO SA  
Chemin des Champs-Courbes 28  
1024 Ecublens - SWITZERLAND

Tel. (+41 21) 695 16 00  
email : info@lemo.com  
www.lemo.com

**PSA.1Y.405.CTAC\_\_**