

Outer shell	: Stainless steel (AISI304L)	-
Collet nut + clamps + screw	: Stainless steel (AISI304L)	-
Insulator	: PEEK	-
Female contact	: Bronze (UNS C54400)	Gold plated (ISO 27874)
Clip	: Cu-Be (UNS C17200)	-
Clip	: Stainless steel (AISI416)	-
Gland	: EPDM	-
Other outer metallic parts	: Stainless steel (AISI304L)	-
Other inner metallic parts	: Brass (UNS C38500)	Nickel plated (FS-QQ-N-290A)
O-rings	: EPDM	-
Marking strip	: Epoxy paint	Black

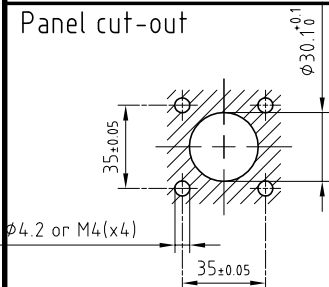

Crimping tool : DPC.91.101.A
 Extractor : DCF.91.163.5LT
 Female contact : EGG.4B.670.ZZM
 Female positioner : DCE.91.164.BVCM

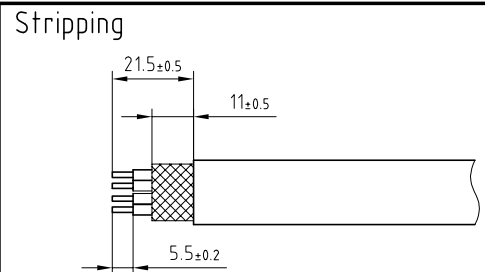

**Fixed socket with square flange , 4 screws fixing ,
 with cable clamps .
 Series 4N , multipole (10)**

ETUDE N° E6224

Echelle	Dessiné	11.04.2016	OVU / NHA
	Contrôle	11.04.2016	NHA / ATVI
	Modif.	00	11.04.2016/ OVU



CH-1024 Ecublens

PBG.4N.310.TYMY _ _