

Outer shell	: Stainless steel (AISI304L)	-
Latch sleeve	: Stainless steel (AISI416)	-
Inner shell	: Brass (UNS C38500)	Nickel plated (FS-QQ-N-290A)
Front ring	: Stainless steel (AISI304L)	-
Insulators	: PEEK	-
Male contact (Power)	: Brass (UNS C34200)	Gold plated (ISO 27874)
Female contact (LV)	: Bronze (UNS C54400)	Gold plated (ISO 27874)
Clips	: Cu-Be (UNS C17200)	-
Earthing washer	: Brass (UNS C27400)	Plated CuSnZn
Other metallic parts	: Brass (UNS C38500)	Nickel plated (FS-QQ-N-290A)
O-ring	: Silicone (MVQ)	-
<b>Female fiber-optic contact</b>	: <b>(PSS.FS.BA2.YCE30)</b>	<b>(See customer drawing)</b>

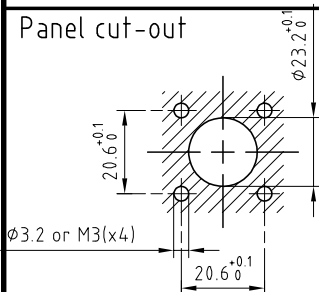

Assembly instruction per document n° \_\_

**Straight plug , round flange , with keys (W) ,  
4 holes fixing , with earthing washer .  
Series 3K , 2FO(typeF2 (Sony) + 2LV(Ø0.9) + 2power(Ø1.3)**

ETUDE N° E7151-E9084

Echelle —	Dessiné	17.12.2018	OVU / NHA
	Contrôle	17.12.2018	NHA / ATVI
	Modif.	00	17.12.2018 / OVU



**LEMO**

LEMO SA  
Chemin des Champs-Courbes 28  
1024 Ecublens - SWITZERLAND

Tel. (+41 21) 695 16 00  
email : info@lemo.com  
www.lemo.com

**FXW.3K.93C.YSE**