

Outer shell	: PEEK	-
Coupling nut	: PEEK	-
Insulator	: Silicone (HTVR)	-
Female contact	: Bronze (UNS C54400)	Gold plated (ISO 27874)
Alignment tube	: Stainless steel (AISI304L)	-
Label	: Polyester	-

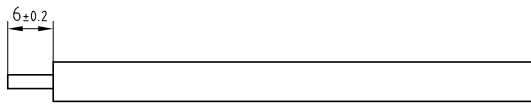

1. Verify using gloves the connector is clean , if not clean carefully . Strip the cable according to the given dimension .

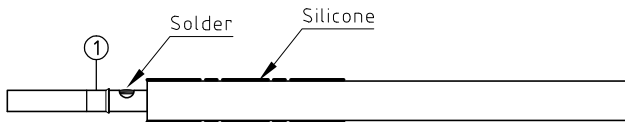

2. Slide the conductor into the contact ① until the dielectric of the cable strike against the contact and solder . Make sure that there is no solder over thickness . Apply a layer of RTV 162 or equivalent to the cable dielectric .

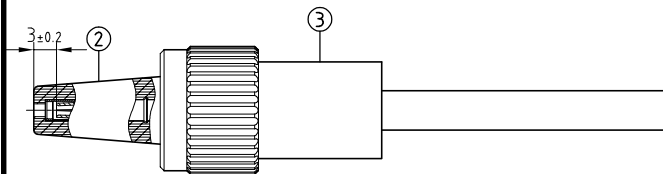

3. Introduce the contact pre-assembly into the insulator ② of the plug shell ③ . Check that the contact claw is correctly positioned in the interior groove of the insulating , the position must be  $3\pm 0.2$ mm from the front of the insulating .

**Straight plug with screw lock .  
Series HY , (1) HV**

ETUDE N° E4163

Echelle —	Dessiné	20.04.2020	OVU / NHA
	Contrôle	20.04.2020	NHA / CDE
	Modif.	00	20.04.2020 / OVU



**LEMO**

LEMO SA  
Chemin des Champs-Courbes 28  
1024 Ecublens - SWITZERLAND

Tel. (+41 21) 695 16 00  
email : info@lemo.com  
www.lemo.com

**FVP.HY.430.GFLT52**