

Outer shell : Brass (UNS C38500)  
 Earthing crown : Brass (UNS C38500)  
 Insulator : PEEK  
 Male contact : Brass (UNS C34200)  
 Clip : Cu-Be (UNS C17200)  
 Other metallic parts : Brass (UNS C38500)  
 O-rings : Silicone (MVQ)

Chrome plated (FS-QQ-C-320B)  
 Nickel plated (FS-QQ-N-290A)  
 -  
 Gold plated (ISO 27874)  
 -  
 Nickel plated (FS-QQ-N-290A)  
 -

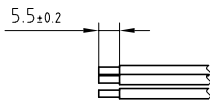

1. Strip the cable according to the given dimensions .

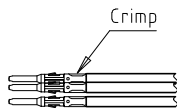

2. Fix the positioner on the crimping tool and set selector to the number corresponding to the AWG as indicated on the positioner label . Fit conductor into the contacts and make sure it is visible through its inspection hole in the crimp barrel . Open crimping tool then push contact fully into positioner and complete one crimping cycle . Remove from crimping tool and check that conductor is secure in contact and shows in inspection hole .

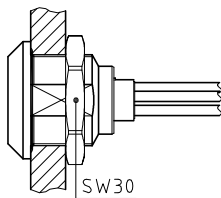

3. Drill the panel hole and install the connector with the appropriate tool . Slide crimped contact-conductor combinations according to the insulator marking by avoiding to twist the conductors . Introduce lightly the contacts into the insulator and verify that no conductors are crossed before pushing them completely . Check that all contacts hold in the insulator by verifying their alignment at the front of the insulator and they should remain in position when given a gentle pull to each conductor .

Panel cut-out

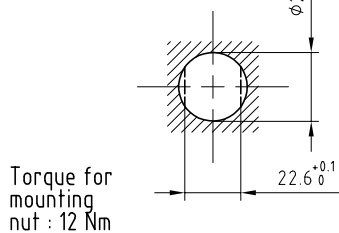

Crimping tool : DPC.91.101.A  
 Extractor : DCF.91.163.5LT  
 Male contact : FGG.3B.570.ZZC  
 Male positioner : DCE.91.163.BVCM

**Fixed socket with nut fixing , with keys (L) ,  
 with extended insulator .  
 Series 3K , multipole (5)**

ETUDE N° E1461-E6041

Echelle	Dessiné	12.03.2019	OVU / NHA
	Contrôle	12.03.2019	NHA / ATVI
	Modif.	00	12.03.2019/ OVU



**LEMO**

LEMO SA  
 Chemin des Champs-Courbes 28  
 1024 Ecublens - SWITZERLAND

Tel. (+41 21) 695 16 00  
 email : info@lemo.com  
 www.lemo.com

**EGL.3K.305.CYC**