

| | | |
|---------------------------------|------------------------------|-------------------------------|
| Outer shell | : Stainless steel (AISI304L) | - |
| Earthing crown | : Brass (UNS C38500) | Nickel plated (FS-QQ-N-290A) |
| Insulators | : PEEK | - |
| Male contact (LV) | : Brass (UNS C34200) | Gold plated (ISO 27874) |
| Female contact (Power) | : Bronze (UNS C54400) | Gold plated (ISO 27874) |
| Clips | : Cu-Be (UNS C17200) | - |
| Earthing washer | : Brass (UNS C27400) | Plated CuSnZn |
| Other metallic parts | : Brass (UNS C38500) | Nickel plated (FS-QQ-N-290A) |
| O-rings | : Silicone (MVQ) | - |
| Male fiber-optic contact | : (FFS.FS.BA.2.YCE30) | (See customer drawing) |

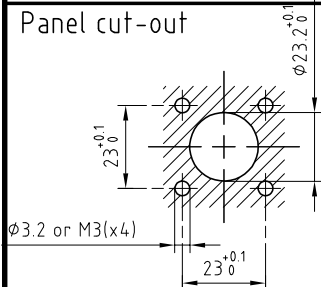

Assembly instruction per document n° __

**Fixed socket , square flange , with keys (W) ,
4 holes fixing , with earthing washer .
Series 3K , 2F0(typeF2 (Sony) + 2LV(φ0.9) + 2power(φ1.3)**

ETUDE N° E7151

| | | | |
|--------------|----------|------------|-----------------|
| Echelle — | Dessiné | 14.12.2018 | OVU / NHA |
| | Contrôle | 14.12.2018 | NHA / ATVI |
| | Modif. | 00 | 14.12.2018/ OVU |



LEMO

LEMO SA
Chemin des Champs-Courbes 28
1024 Ecublens - SWITZERLAND

Tel. (+41 21) 695 16 00
email : info@lemo.com
www.lemo.com

EDW.3K.93C.YSE