

Outer shell	: Stainless steel (AISI304)	-
Insulator	: PEEK	-
Female contact	: Bronze (UNS C54400)	Gold plated (ISO 4523)
Other metallic parts	: Stainless steel (AISI304)	-
O-rings	: EPDM	-
Marking strip	: Epoxy paint	black

Panel cut-out

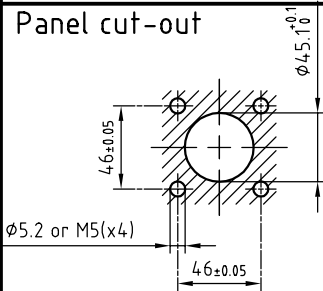

**Straight socket with square flange , 4 screw fixing ,  
with long pre-positioning sleeve .  
Series 5N , multipole (20)**

ETUDE N° E6225

Echelle

Dessiné	12.06.98	FNI /ATAB
Contrôle	26.08.02	RMO / CDE
Modif.	01	26.08.02 / OVU



**LEMO**

CH-1024 Ecublens

**EDG.5N.320.TLL**