

Outer shell	: Stainless steel (AISI304)	-
Insulator	: PEEK	-
Male contact	: Brass (UNS C34500)	Gold plated (ISO 4523)
Clip	: Cu-Be (UNS C17200)	-
Other metallic part	: Stainless steel (AISI304)	-
O-rings	: EPDM	-
Marking strip	: Epoxy paint	Black

Panel cut-out

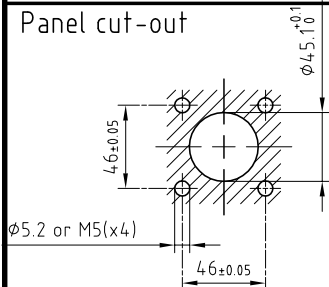

Crimping tool : DPC.91.101.A
 Extractor : DCC.91.202.5LA
 Male contact : FGG.5B.575.ZZC
 Male positioner : DCE.91.205.BVCM

**Straight socket with square flange ,
 4 screw fixing .
 Series 5N , multipole (14)**

ETUDE N° E6225

Echelle —	Dessiné	18.07.2013	OVU /JPBA
	Contrôle	18.07.2013	JPBA/ATVI
	Modif.	00	18.07.2013/ OVU



LEMO

CH-1024 Ecublens

EDG.5N.314.TLC